

BROOKLINE 9TH ELEMENTARY SCHOOL FEASIBILITY STUDY

OPTION B.1

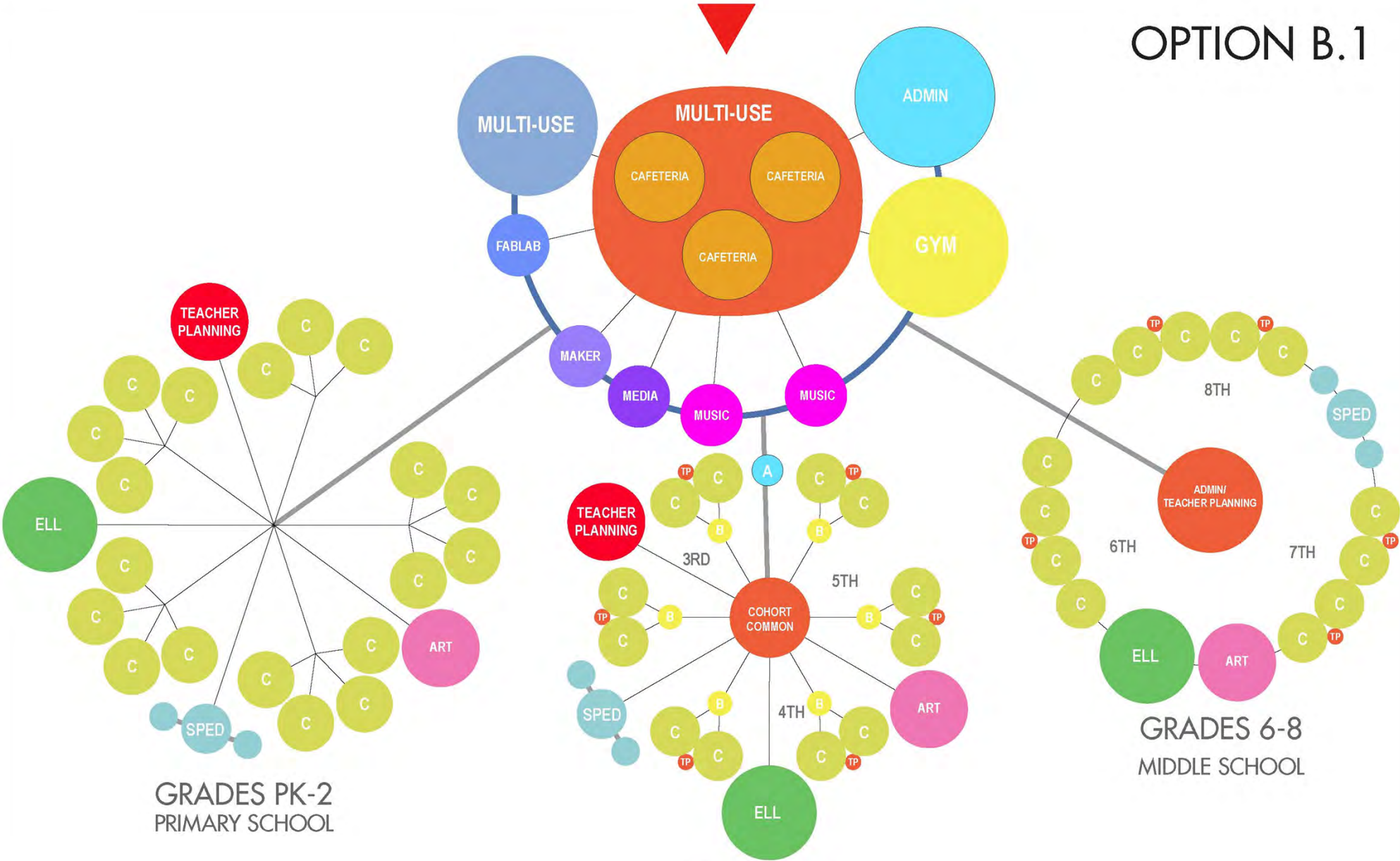

















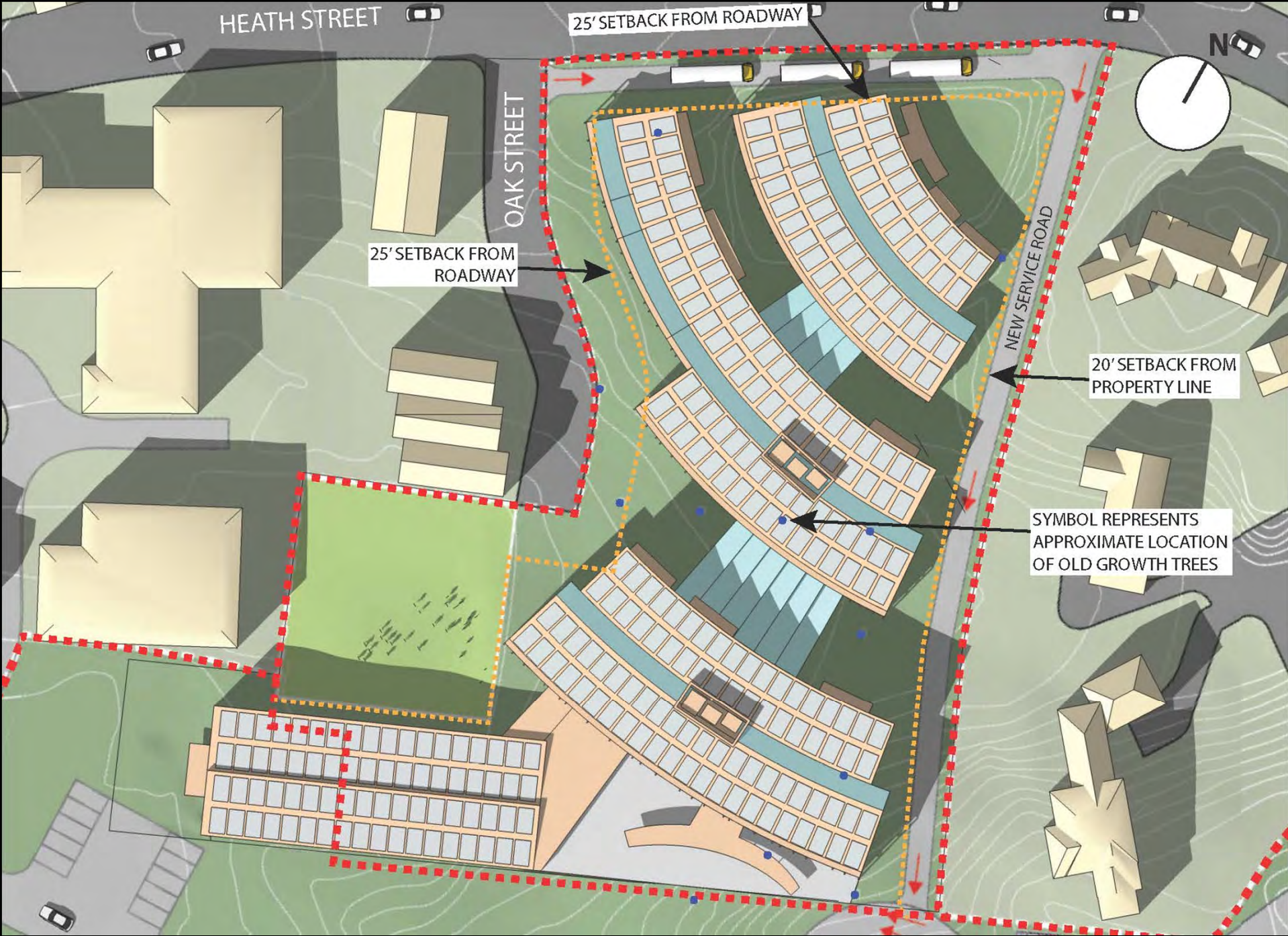









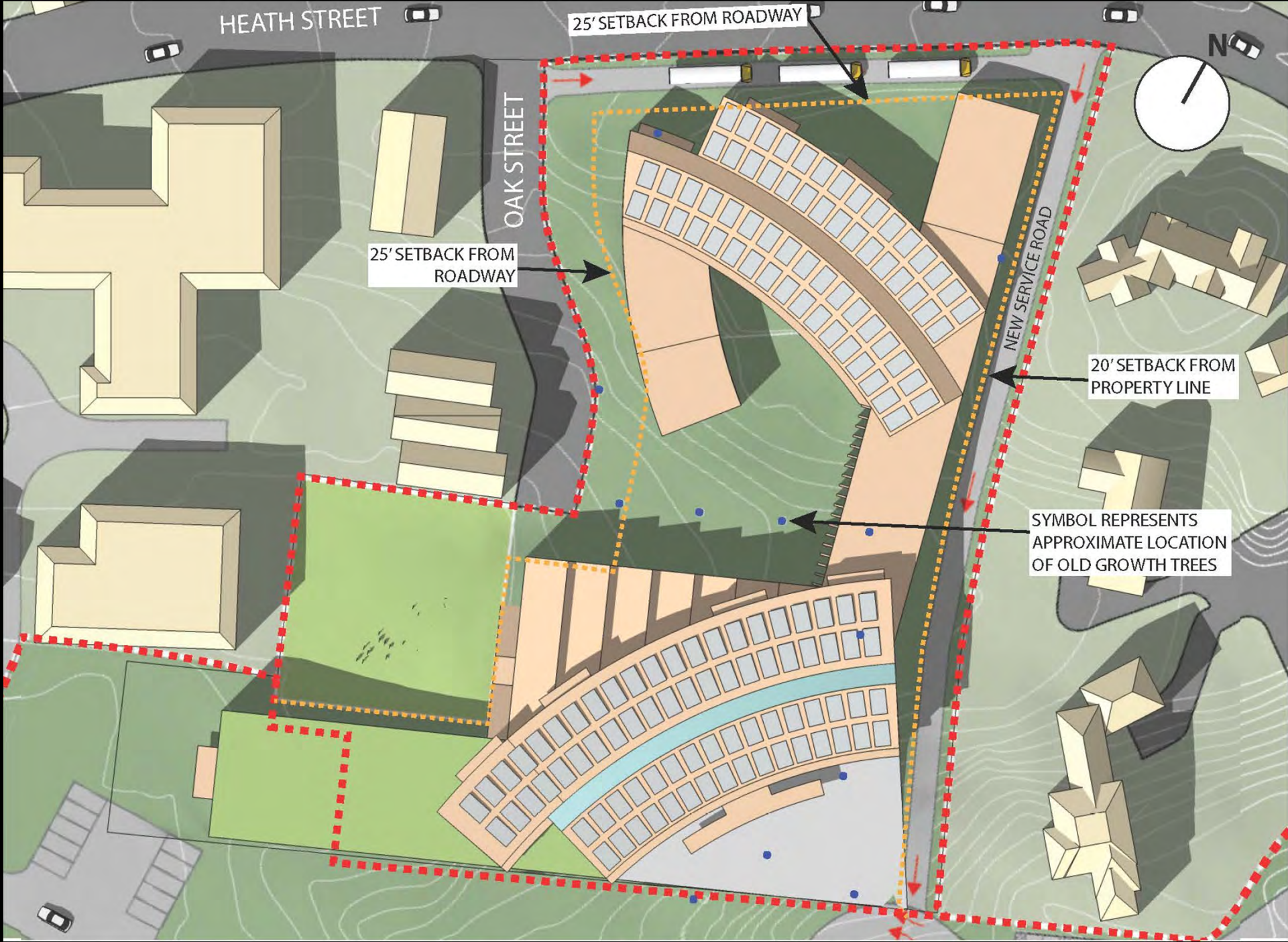



SOULE SITE WORK - ALTERNATIVE A

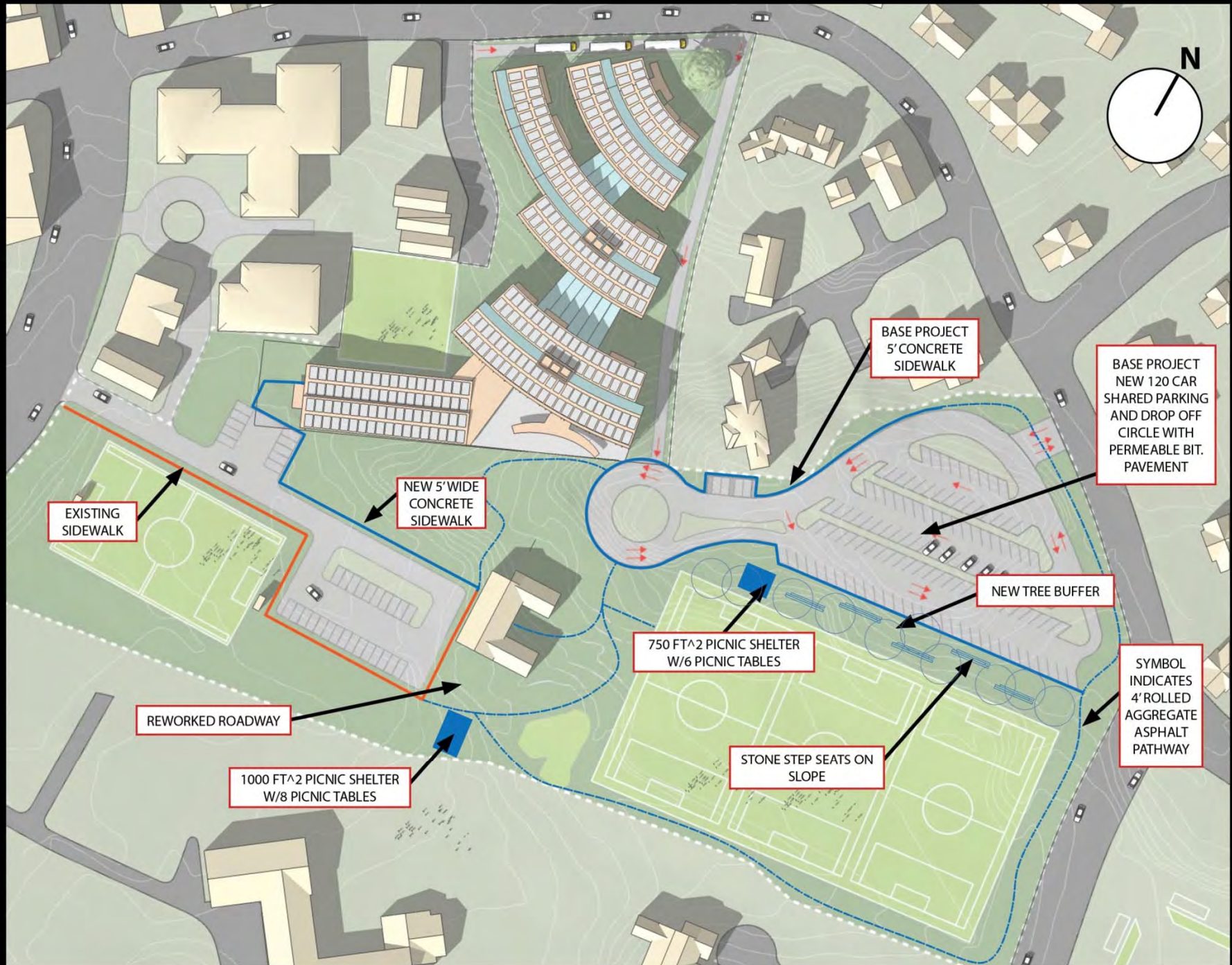

SOULE SITE WORK - ALTERNATIVE B

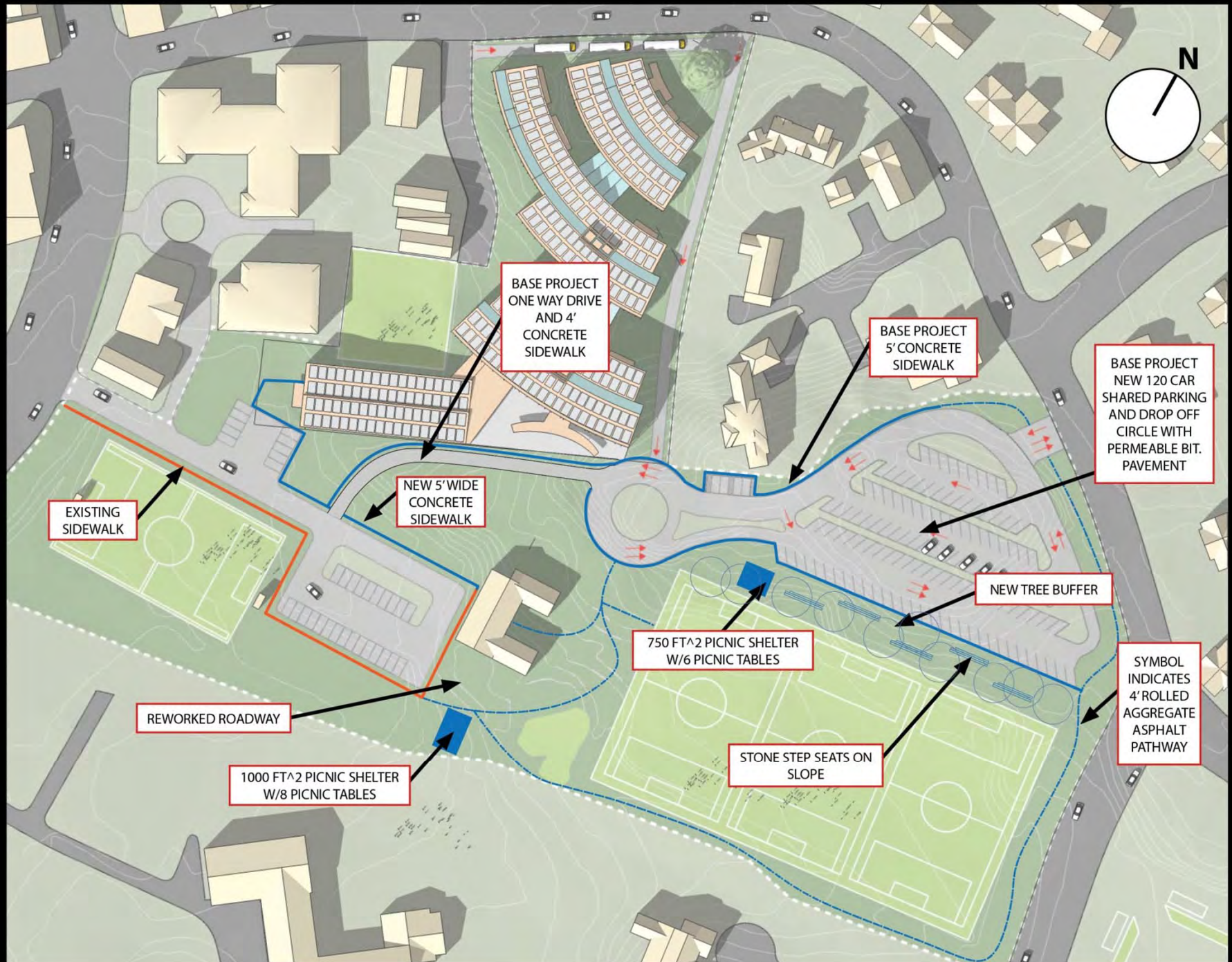

SOULE SITE WORK - ALTERNATIVE C

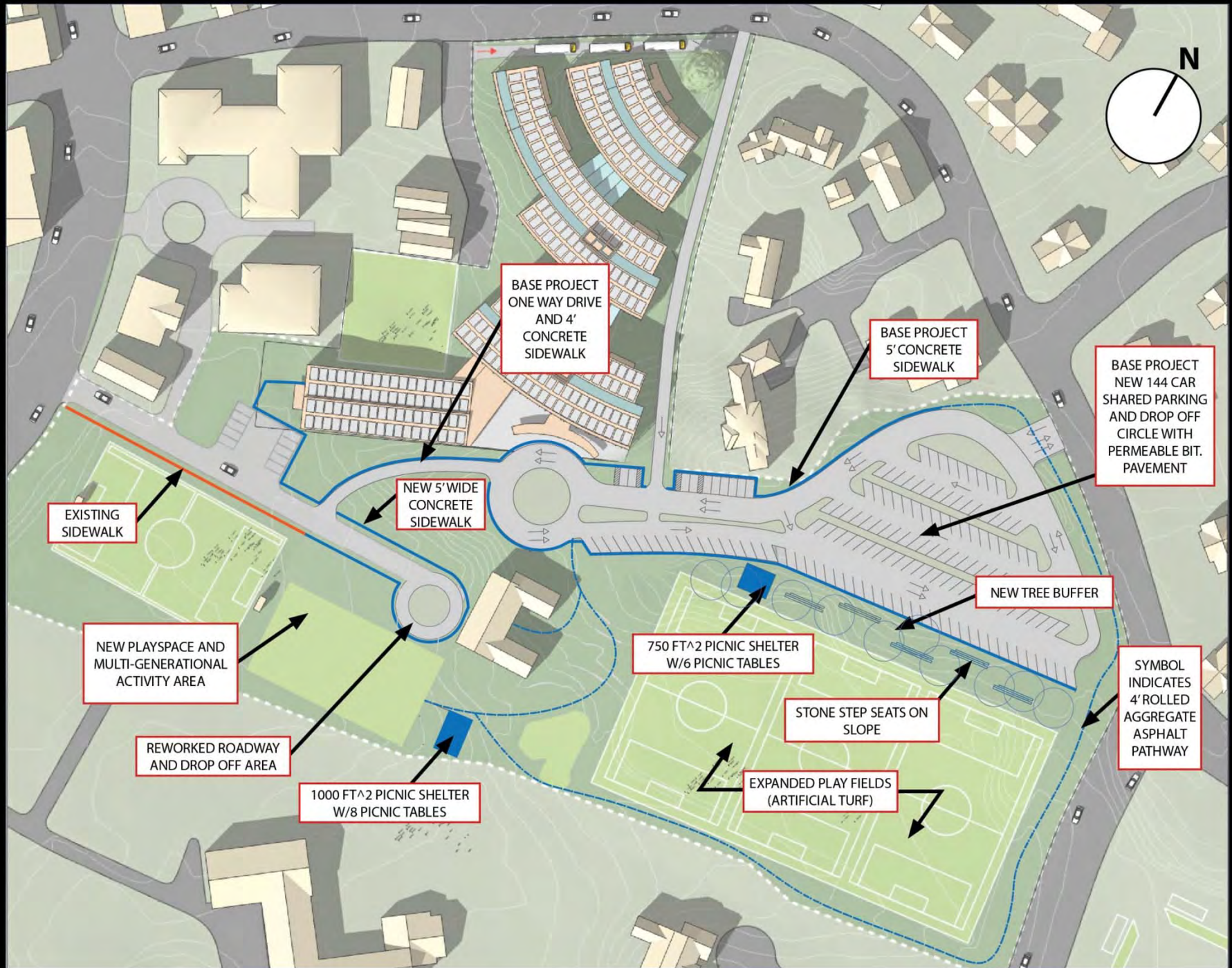

PRE-SCHEMATIC ALTERNATIVES EVALUATION

BROOKLINE 9TH ELEMENTARY SCHOOL
 EVALUATION MATRIX FOR ALTERNATIVE DESIGN STRATEGIES
 1/24/2017

KEY	+	Advantageous
	o	Neutral
	-	Disadvantageous

PROJECT EVALUATION CRITERIA	OPTION A	OPTION D	OPTION E	Comments
1 TOTAL PROJECT COST				INCLUDES WORK AT SOULE
801 STUDENT - TOTAL (MILLION)	\$88.8	\$89.9	\$89.4	
801 STUDENT - COST PER STUDENT (K)	\$111	\$112	\$112	
612 STUDENT - TOTAL (MILLION)	\$82.3	\$85.2	\$84.0	
612 STUDENT - COST PER STUDENT (K)	\$134	\$139	\$137	
2 TRAFFIC	o	o	o	ALL OPTIONS EFFECTIVELY IDENTICAL
3 OPEN SPACE	o	+	o	D HAS MOST OPEN SPACE
4 IMPACT TO NEIGHBORS	o	+	+	D AND E HAVE SMALLEST APPARENT MASSING, RESIDENTIAL SCALE FACING NEIGHBORS
5 SAFETY - OUTSIDE SCHOOL BUILDING	o	o	-	SOME E COURTYARD AREA NOT VISIBLE FROM EXTERIOR
6 SECURITY - INSIDE SCHOOL BUILDING	o	+	o	D HAS CLEAREST LINES OF SIGHT
7 EDUCATION PLAN ENHANCEMENT	o	+	o	2 GROUP COMMONS FACILITATE COLLABORATION
8 CLASSROOM SHAPES AND ADJACENCIES	o	o	o	ALL OPTIONS EFFECTIVELY IDENTICAL
9 COHORT CONFIGURATION	+	+	o	A AND D HAVE MOST CLEARLY DEFINED COHORTS
10 BENEFICIAL RELATIONSHIP WITH SOULE	+	+	+	ALL OPTIONS ENLARGE FIELDS, REBUILD CURRENTLY INACCESSIBLE GYM
11 COMMUNITY USE	+	+	+	ALL OPTIONS ALLOW COMMUNITY USE OF GYM AND AUDITORIUM
12 FLEXIBILITY OF USE - FUTURE USE	o	o	o	ALL OPTIONS EFFECTIVELY IDENTICAL
13 LEED /SUSTAINABILITY / DAYLIGHTING	+	+	o	A AND D HAVE BEST SOLAR ORIENTATION
14 BUILDING MASSING/SITE COVERAGE	o	+	+	D AND E MORE HUMAN SCALE
15 OUTDOOR PLAY AREA	o	o	o	ALL OPTION COMPARABLE
16 MEP ACCOMMODATION	+	+	o	SOLAR ORIENTATION IMPACTS ENERGY LOADS
17 ATHLETIC USE	+	+	+	ALL OPTIONS TO HAVE NEW FACILITIES AND ACCESS TO ENLARGED SOULE UPPER FIELDS
18 DELIVERIES	o	o	o	ALL OPTIONS EFFECTIVELY IDENTICAL
19 SCHEDULE DURATION / RISK	o	o	o	ALL OPTIONS EFFECTIVELY IDENTICAL
20 SITE REMEDIATION	o	o	o	ALL OPTIONS EFFECTIVELY IDENTICAL
21 HAZARDOUS MATERIAL REMOVAL	o	o	o	ALL OPTIONS EFFECTIVELY IDENTICAL
22 LONG TERM MAINTENANCE / REPAIR COST	o	o	-	E HAS MOST EXTERIOR SKIN
23 OPERATING COST	+	+	o	SOLAR ORIENTATION AND EXT SKIN QUANTITY IMPACT ENERGY LOADS